



# Powered Air Purifying Respirators

AVAILABLE FROM THE FOLLOWING AUTHORISED DISTRIBUTOR



**ALLENS** Industrial  
Products  
PTY LTD

[www.allensindustrial.com.au](http://www.allensindustrial.com.au)

• BRISBANE • SYDNEY • MELBOURNE  
PH: (07) 3255 6455 PH: (02) 8072 4162 PH: (03) 9081 0172

# Powered Air Purifying Respirators.

Powered Air Purifying respirators (PAPRs); include a blower that draws contaminated air through filter/s to remove contaminants, supplying purified air to the user wearing either an open head top (loose fitting hood) or tight-fitting face mask. Like full and half face masks, PAPRs are also available in ready-packs to simplify the respiratory selection process.

### 3M offers a range of ready-to-go PAPR kits:

- Full face masks for asbestos and dust applications
- Half and full hood head tops ideal for chemical and pharmaceutical industry
- Helmets and face shields ideal for welding applications.

### The benefits of a PAPR are:

- Protection factors up to 100+, based on the headtop and filter/cartridge being used
- Good option if using for long periods by reducing the weight of a filter carried on a face mask
- Helps prevent user fatigue with air moving around the head and face cooling the wearer
- Available with a wide range of open and closed head tops (hoods & masks).

These features make PAPRs ideal for industries such as; asbestos removal, pharmaceutical manufacture, smelters, waste control, land remediation, welding and agriculture. With any negative pressure or PAPR RPE the selection and use of the correct filter for the contaminant/hazard is crucial. Filters are typically designed to handle particulates, gas/vapour or a combination of both particulate and gas.

The life of a gas cartridge is dependent upon the temperature, humidity, concentration and type of contaminant, the class of filter and the rate of breathing of the wearer. Filters should be replaced on a regular basis in accordance with an established filter replacement schedule identified in the initial risk assessment. AS/NZS 1716: 2012 recommends discarding your filter when any one of the following conditions exists:

- The particulate filter becomes difficult to breathe through
- Breakthrough gas occurs; indicated by smell or taste or according to the filter replacement schedule identified during the risk assessment
- 6 months has passed since sealed gas/vapour filter package has been opened
- The expiry date on the filter has passed.

In some instances, depending on the type of chemical hazard, filters must be changed out after each shift.

If filters are to be re-used they should be stored in a sealed plastic bag or box.

### Filter classifications:

#### Particulate Filters are classified as P1, P2 or P3:

- P1 filters handle mechanically generated particles
- P2 filters handle mechanical & thermally generated particles
- P3 filters handle mechanical & thermally generated particles

#### Gas filters are rated Class 1, Class 2 or Class 3 according to their capacity to capture and hold certain gas/vapours

The classification for gas & vapour filters is based on the groups of gases they are designed to be most effective against. Filters have colour-coded labels for easy identification of the different groups.

# Experience maximum flexibility as you move from one job to the next.

## New levels of comfort and simplicity

3M offers an extensive and flexible range of powered and supplied air respirators developed for a wide range of environments, applications and hazards.

These respiratory protective systems offer comfortable, integrated protection against multiple hazards providing respiratory, head, face, eye and hearing protection. Their ease of use can improve productivity in the workplace.

- 1 All 3M™ Versaflo™ Brand Products are light-weight, compact and well-balanced
- 2 Two-position adjustable airflow feature distributes air where the user wants
- 3 Multiple size adjustment options allow for a comfortable fit
- 4 Equipped with automatic flow control, low battery alarm, and low flow alarm
- 5 QRS (Quick Release Swivel) breathing tubes allow fast and easy connection
- 6 Provides excellent peripheral and downward vision
- 7 Easily removable parts allow simple cleaning, maintenance and replacement
- 8 The air inlet draws air from the bottom of the unit, allowing the wearer to sit without blocking the airflow intake



# Which air system should I choose?

### A powered air system?

- Incorporates a battery powered motorised fan to draw air through a filter
- Cannot be used to protect against substances with poor warning properties (taste/smell)
- Must not be used in conditions that are Immediately Dangerous to Life or Health (IDLH)
- Suitable for use over long shifts - reduced breathing resistance
- Can offer integrated head, eye and face protection

### A supplied air system?

- Air is supplied from a compressor (compressed air must be of breathable quality)
- Can be used to protect against substances with poor warning properties (taste/smell)
- Must not be used in conditions that are Immediately Dangerous to Life or Health (IDLH)
- Suitable for use over long shifts - reduced breathing resistance
- Can offer integrated head, eye and face protection



### Powered Air Respirators



3M™ Versaflo™  
Powered Air  
Turbo TR-300+



3M™ Versaflo™  
Powered Air  
Turbo TR-600



3M™ Versaflo™  
Powered Air  
Turbo TR-800



3M™ Jupiter™  
Powered Air  
Turbo



### Supplied Air Respirators



3M™ Versaflo™  
Supplied  
Air Unit V-100



3M™ Versaflo™  
Supplied  
Air Unit V-200



3M™ Versaflo™  
Supplied  
Air Unit V-300



3M™ Versaflo™  
V-500  
Regulators  
V-Series



Supplied  
Air System  
Stethoscope



## Modular Systems



The modular respirator system is a comprehensive approach to worker protection systems based on comfortable-to-wear modules. All modular headtops, air delivery units and breathing tubes are compatible with one another. Users can mix and match parts as they move from one environment to another, or from one application to the next. It is the ultimate in flexibility for handling changing user environments.

## Individual Systems



The individual respirator systems can be used in a variety of workplace applications. They include powered air respirators with integrated head, eye, face and respiratory protection and supplied air regulators with half and full face masks.

## Selection process for modular systems.

### Powered air systems

#### Stage 1A

Select Powered Air Turbo\*

#### Stage 1B

Select Filters, Battery and Belt



#### Stage 2

Select your Headtop



#### Stage 3

Select your Breathing Tube



#### Stage 4

Choose Accessories



\*Want an even easier way to select a system? Choose 3M's powered air starter kits, which include everything apart from the headtop and some accessories.

### Supplied air systems

**Stage 1**  
Select your  
Regulator



**Stage 2**  
Select your  
Headtop



**Stage 3**  
Select your  
Breathing Tube



**Stage 4**  
Select your  
Compressed  
Air Supply Tube



**Stage 5**  
Choose Accessories



## Modular respirator systems.

**3M™ Versaflō™ Headcovers and Hoods S-Series**

Integrated Suspension      Reusable Suspension

S-133 S/L      S-433 S/L      S-655  
S-333G S/L      S-533 S/L      S-657  
S-757      S-855E

**3M™ Versaflō™ Headtops M-Series**

Faceshields      Helmets      Helmets with Shrouds

M-206      M-306      M-406  
M-207      M-307      M-407

**Breathing tubes**

BT-20 S/L: Lightweight (in two lengths)  
BT-30: Self-adjusting  
BT-40: Heavy-duty rubber

BT-20 S/L      BT-30      BT-40

**Powered air turbos**

Particulate only (nuisance level organic vapour and acid gas options available)      Particulate + Gas & Vapour      Intrinsically Safe Particulate + Gas & Vapour      Particulate + Gas & Vapour      Intrinsically Safe Particulate + Gas & Vapour

3M™ Versaflō™ Powered Air Turbo TR-300+      3M™ Versaflō™ Powered Air Turbo TR-600      3M™ Versaflō™ Powered Air Turbo TR-800 Intrinsically safe      3M™ Jupiter™ Powered Air Turbo      3M™ Jupiter™ Powered Air Turbo with IS Kit

**TR-300 Filter**

- Spark Arrestor
- Prefilter
- P3 Filter
- P3/Nuisance Level Organic Filter
- P3/Nuisance Level Acid Gas (HF up to 10 x WES)

**Battery**

- Standard battery
- High capacity battery

**Charger**

- Single Station Battery Charger
- 4-Station Battery Charger Kit

**TR-600 & TR-800 Filter**

- Spark Arrestor
- Prefilter
- P3 Filter
- P3/Nuisance Level Organic Vapour/Acid Gas
- A1P3 Filter
- ABEHgP3 Filter

**TR-600 Battery**

- Standard Battery
- High Capacity Battery

**TR-600 & TR-800 Chargers**

- Single Station Bat. Charger
- 4-Station Bat. Charger Kit

**TR-830 Battery**

- TR-830 Intrinsic Safe Battery for use with TR-800

## 3M™ 6000 Series Full Face Respirator and 3M™ 7500 Series Reusable Respirator

Full Face



6000

Half Face



7500

## Individual respirator systems.



**Belt-mounted powered air respirator system for asbestos environments**

Proflow SC 160  
Asbestos ReadyPak



**Face-mounted powered air respirator**

3M™ Powerflow™  
Powered Air System



BT-63

BT-64

### Breathing tube accessories

BT-922: Disposable Cover  
BT-926: Flame-resistant Cover  
BT-927: Radiant Heat Cover

### Supplied air regulators

Air Cooling



3M™ Versafo™  
Supplied  
Air Unit V-100

Air Heating



3M™ Versafo™  
Supplied  
Air Unit V-200



3M™ Versafo™  
Supplied  
Air Unit V-300

Flow Controlled



3M™ Versafo™  
Supplied  
Air Regulator V-500



Stethoscope Airline system



### Filter

- Prefilter Pads
- Particulate P3 Filters
- A1P3 Filters
- ABEKP3 Filters



### Battery

- 8 hour Battery
- 4 hour IS Battery



### Charger

- Single Station Battery Charger
- 10-station Multi Battery Charger

### Airline accessories

#### Air Supply Tube



## 3M™ Versaflo™ TR-800 Powered Air Purifying

- The Versaflo TR-800 features a PAPR blower UL-certified with an intrinsically safe (IS) rating of Division 1: IS Class I, II, III; Division 1 (includes Division 2) Groups C, D, E, F, G; T4, under the most current standard (UL 60079, 6th Edition, 2013).
- LED indicators on the turbo indicate battery charge level, particulate filter loading status and airflow setting
- Low flow and low battery alarms - Visual, Audible and Vibratory
- Vibratory, audible and visual alarms assure you can hear, see and feel when your PAPR has low-charge or low-flow
- Compatible with multiple configurations of headtops, breathing tubes, batteries, filters, cartridges and more
- Ergonomically designed to fit close to the body and allow for greater movement in tight work spaces
- Multi-speed blower functions at altitudes up to 4,880 metres. Battery offers long run time and charges quickly, achieving 90% charge in approximately 3.5 hours.
- Multiple airflow rates put you in control of your comfort.
- Battery comes with built in charge level indicator, a mechanical attachment of battery to help prevent battery removal during use. Approximately 750 full charge/discharge cycles.
- Intuitive, coloured touchpoints plus visual and audible lowflow indicators help make the TR-800 easy to use.



### Comfortable airflow

- Three user selectable flow rates to maximise comfort
- Controlled airflow delivers steady flow as battery discharges or filter loads with particulates



### Innovative materials

### Ease of use

- Intrinsically safe TR-800 Series display shows battery charge status and particulate filter loading status during use
- **Battery charge indicator** - charge status is also indicated by a useful LED display on the battery



- No user calibration of turbo required
- Electronic audible and visual alarm in case of low battery and/or low air flow

### Battery Protection

Battery features bumpers to help absorb impacts



### Easy identification

Bright yellow touchpoints to differentiate from non-IS versions of Versaflo Product Family

### Secure battery attachment

Mechanical attachment of battery to help prevent battery removal and spark risk during use per EN 60079-11

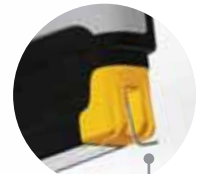

### Motor/Blower Safety

| 3M Order Code | Model # | Description  |
|---------------|---------|--|
| 70071732666   | TR-819A | TR-819A IS PAPR Starter Kit including battery and charger 1/CS |
| 70071697117   | TR-830  | Battery, Intrinsically safe 1/CS*                              |
| 70071697133   | TR-851  | Filter latch assembly  |
| 70071697125   | TR-838  | Battery attachment tool  |
| 70071730900   | TR-802E | PAPR Motor/Blower 1/CS   |

\*purchase filter and filter cover separately.

### Mining Atmospheres IEC 60079-11 Ex ia IMA

ia - intrinsic safety- safe with rare malfunction  
I - Mining group  
Ma - Equipment protection level mining

### Non-Mining Gas atmospheres (Group II) EN 60079-11 Ex ia IIB T4 Ga

ia - intrinsic safety for Equipment protection level Ga  
IIB - Gas apparatus group  
T4 - Max. surface temperature 135°C (-20°C ≤ Ta ≤ 55°C)

### Non-Mining Dust atmospheres (Group III) EN 60079-11 Ex ia IIIC 135°C Da

ia - intrinsic safety for Equipment protection level Da  
IIIC - Dust apparatus group  
135°C - Max surface temperature 135°C (-20°C ≤ Ta ≤ 55°C)



## 3M™ Versaflo™ Powered Air Purifying Respirators TR-600

- LED indicators on the turbo indicate battery charge level, particulate filter loading status and airflow setting
- Low flow and low battery alarms - Visual, Audible and Vibratory
- On-battery fuel gauge
- Vibratory, audible and visual alarms assure you can hear, see and feel when your PAPR has low-charge or low-flow
- Compatible with multiple configurations of headtops, breathing tubes, batteries, filters, cartridges and more
- Ergonomically designed to fit close to the body and allow for greater movement in tight work spaces

AT010620147



| 3M Order Code | Model #      | Description  |
|---------------|--------------|--|
| AT010620170   | TR-619A-P3   | Versaflo™ Powered Air Turbo Starter Kit TR-619A includes battery and charger                               |
| 70071697000   | TR-619A      | Versaflo™ Powered Air Turbo Starter Kit TR-619A includes battery charger, excludes filter and filter cover |
| 70071667862   | TR-602E      | Powered Air Turbo unit   |
| 52000053547   | TR-630       | Standard Battery TR-630  |
| 52000053554   | TR-632       | Versaflo™ High Capacity Battery  |
| 52000053570   | TR-641E      | Single Station Charger to Suit Versaflo™ TR-632 battery  |
| 52000053588   | TR-644E      | 4 Station Charger to Suit the Versaflo™ TR-632 Battery   |
| 70071651692   | TR-655/37385 | Backpack adapter plate 1/C   |
| 78815045279   | TR-627       | Easy Clean belt  |
| 70071622081   | TR-651       | Filter Latch TR-651  |
| 70071618428   | TR-653       | Cleaning & Storage Kit to suit Versaflo™ TR Systems  |
| 70071618253   | TR-662       | Spark Arrestor TR-662 to suit Versaflo™ TR-600   |
| 70071668076   | TR-971       | Airflow Indicator for TR-600 Versaflo™ Unit  |
| 70071730884   | TR-973       | Air Flow Tube TR-600   |
| 78815045279   | TR-627       | Easy Clean Belt with Adaptor plate   |
| 52000053521   | TR-626       | High Durability Belt to Suit TR-602 Versaflo™ AFU  |

### TR-600 & TR-800 Filters

| 3M Order Code | Model #    | Description   |
|---------------|------------|---|
| 70071622073   | TR-6500FC  | Filter Cover to Suit Versaflo™ TR -6580ANZ  |
| UU008996223   | TR-6580ANZ | A1B1E1HgP3 Filter For Organic Vapours, Acid Gases, Inorganic vapours and Mercury vapour including a P3 Filter |
| 70071622065   | TR-6300FC  | Filter Cover to Suit Versaflo™ TR -6310ANZ P3 Filter  |
| UU008996215   | TR-6310ANZ | A1P3 Filter For Organic Vapours includes a P3 filter  |
| 70071618246   | TR-6600    | Versaflo™ Pre-Filter  |
| 70071622040   | TR-6800FC  | Filter Cover to Suit Versaflo™ TR -6820ANZ Nuisance Odour* P3 Filter  |
| UU008996207   | TR-6820ANZ | Nuisance Odour* Plus P3 Filter  |
| 70071618261   | TR-6700FC  | Filter Cover to Suit Versaflo™ TR-6710ANZ   |
| UU008996199   | TR-6710ANZ | High Efficiency Filter Versaflo™  |

### Kits

| 3M Order Code | Model #  | Description  |
|---------------|----------|--|
| AT010620147   | TR6M-307 | 3M™ Versaflo™ TR6M-307 kit includes TR-619A with M-307 Headtop and P3 filter |
| AT010620154   | TR6M-407 | 3M™ Versaflo™ TR6M-407 kit includes TR-619A with M-407 Headtop and P3 filter |

## PAPR Breathing Hoses



BT-20 S/L

BT-30

BT-40

| 3M Order Code | Model # | Description  |
|---------------|---------|--|
| 70071533015   | BT-20L  | Fixed length lightweight Polyurethane Breathing Tube L=965mm |
| 70071533023   | BT-20S  | Fixed length lightweight Polyurethane Breathing Tube L=735mm |
| XA007706584   | BT-30   | Self-adjustable Polyurethane Breathing Tube L=525-850mm      |
| UU003085113   | BT-40   | Fixed length Heavy Duty Neoprene Breathing Tube L=840mm      |
| XA007706527   | BT-922  | Breathing Tube Cover - 1 per case                            |
| 70071564432   | BT-926  | Flame Resistant Breathing Tube Cover - 1 per case            |

## BT-63 & BT-64 Breathing Tube

For use with the 7500 half face and 6000 series full face respirators on the TR-600 or TR-800 PAPR Units.



70071730934

70071730876

| 3M Order Code | Model # | Description  |
|---------------|---------|--|
| 70071730876   | BT-64   | Versaflo™ Heavy Duty Tight Fitting Breathing Tube BT-64 1 EA/Case                        |
| 70071730934   | BT-63   | Versaflo™ Length Adjusting Tight Fitting Breathing Tube BT-63 1/Case                     |
| 70071730892   | BT-953  | Versaflo™ Cleaning & Storage Kit BT-953, for BT-63/64 Breathing Tubes 1/case             |
| 70071730884   | TR-973  | Versaflo™ Air Flow Indicator TR-973, for TR-600 PAPR with BT-63/64 Breathing Tube 1/case |

# Powered Air Purifying Respirators

## 3M™ Versaflo™ Powered Air Purifying Respirators TR-300+

The 3M™ Versaflo™ PAPR TR-300 is significantly lighter and thinner than past generations of 3M™ Belt-Mounted PAPR units. It also keeps its light weight close to the user's back, reducing the leverage effect that can cause PAPRs to feel heavier. The slim profile is designed for use in tight spaces, and its smooth, contoured outer surfaces are less prone to snagging on nearby objects.

- Two user selectable flow rates 185 & 205 l/min
- Controlled airflow delivers steady flow as battery discharges or filters loads with particulates
- Display shows battery charge status, selected airflow and particulate filter loading status during use
- Audible and LED alarm signals low battery charge or low airflow
- Three filter options available: P3 Particle, P3 Particle plus nuisance level organic vapours\* & P3 Particulate only nuisance acid gas \* and offers protection against hydrogen fluoride up to 10 x Occupational Exposure Limit
- Lithium ion battery with LED to indicate charge status
- Three belt options (standard, easy-clean and leather) for a range of applications
- Suitable for use in decontamination shower (IP 53)
- Nuisance level refers to concentrations below the Occupational Exposure Limit
- Compliant with AS/NZS 1716:2012



### TR-315A+ Filters & accessories

| 3M Order Code | Model #  | Description                             |
|---------------|----------|---|
| AT010592650   | TR-3600  | Versaflo™ Prefilter                     |
| 78815069378   | TR-3712E | Versaflo™ Filter Particulate, P3        |
| 78815069386   | TR-3802E | Filter P3 plus Nuisance Organic Vapour  |
| 78815069394   | TR-3822E | Filter P3 & HF Plus Nuisance Acid Gases |
| UU008566075   | TR-302E  | Air Filter Unit                         |
| XA007706568   | TR-332   | Battery Pack                            |
| AT010590274   | TR-341A  | Single Station Battery Charger          |
| AT010590282   | TR-344A  | Quad Station Battery Charger            |

| 3M Order Code | Model #  | Description  |
|---------------|----------|--|
| AT010590241   | TR-315A+ | Versaflo™ Integrated Powered Air Respirator system includes air filter unit, P3 Filter, standard belt, pre-filter, breathing tube, battery pack, battery charger, tote bin and user instructions |

## 3M™ Versaflo™/TR-300+ Integrated PAPR Systems Kits

Versaflo™ Integrated Powered Air Respirator system includes Headtop, air filter unit, P3 Filter, standard belt, pre-filter, breathing tube, battery pack, battery charger, tote bin and user instructions

The Versaflo™ S-Series headtops are designed to be used with an approved 3M air delivery unit to form a respiratory protective device. The headtops are available in Spun bond polypropylene and Polyurethane coated knitted nylon.



| 3M Order Code | Model #  | Description  |
|---------------|----------|--|
| AT010590514   | TRM-106C | TR-300+ PAPR Kit c/w M-206C Faceshield Comfort F/Seal c/w Charger and P3 Filter          |
| AT010590522   | TRM-107C | TR-300+ PAPR Kit c/w M-207C Faceshield Flame Resistant F/Seal with Charger and P3 Filter |
| AT010590530   | TRM-306C | TR-300+ PAPR Kit c/w M-306C Helmet Comfort F/ Seal c/w Charger and P3 Filter             |
| AT010590548   | TRM-307C | TR-300+ PAPR Kit c/w M-307C Helmet Flame Res. F/seal c/w Charger and P3 Filter           |
| AT010590555   | TRM-406C | TR-300+ PAPR Kit c/w M-406C Hi-Dura Shroud c/w Charger and P3 Filter                     |
| AT010590563   | TRM-407C | TR-300+ TR-300+ PAPR Kit c/w M-407C Helmet Flame Res. Shroud) c/w Charger and P3 Filter  |
| AT010591447   | TRS-133C | TR-300+ PAPR Kit c/w S-133 Head cover c/w Charger and P3 Filter                          |
| AT010591454   | TRS-333C | TR-300+ PAPR Kit c/w S-333 Head cover c/w Charger and P3 Filter                          |
| AT010591462   | TRS-433C | TR-300+ PAPR Kit c/w S-433 Integrated Head Harness Hood c/ w Charger and P3 Filter       |
| AT010591470   | TRS-533C | TR-300+ PAPR Kit c/w S-533 Integrated Head Harness Hood c/ w Charger and P3 Filter       |
| AT010591488   | TRS-655C | TR-300+ PAPR Kit c/w S-655 Reusable Head Harness Hood c/ w Charger and P3 Filter         |
| AT010591496   | TRS-657C | TR-300+ PAPR Kit c/w S-657 Reusable Head Harness Hood c/ w Charger and P3 Filter         |
| AT019433567   | CAPM-306 | TR-300+ PAPR Kit c/w M-306 with cap lamp mount c/w charger and P3 filter                 |
| AT010602756   | 6800-TR  | TR-300+ PAPR Kit c/w 6800DIN Full Face c/w charger and P3 Filter                         |

# Versaflo™ M-200 Series High Impact Faceshield

The Versaflo M-200 Series High Impact Faceshield provides integrated protection from specific respiratory, eye and face hazards with optional hearing protection. Two options for different applications:

- M-206 features a general purpose faceseal for dusts, spraying and chemical processing.
- M-207 features a flame resistant faceseal for applications with hot particles
- M-200 offers a full headtop protection, eliminating the need of head inserts being needed.
- Compatible with TR-300+, TR-600, TR-800, Jupiter units and supplied air regulators V-100, V-200, V-300, V-500
- M-200 has replaced M-100 Series Headtop



| 3M Order Code | Model # | Description  |
|---------------|---------|--|
| UU009054808   | M-206   | Faceshield with Comfort Faceseal replaces M-106                      |
| UU009055615   | M-207   | Faceshield with FR PolyFaceseal                                      |
| 70071544970   | M-170   | Versaflo M-100 Faceshield Head Inserts                               |
| UU003029491   | M-150   | Head Suspension - 1 per case   |
| UU003029723   | M-154   | Forehead Seal - 1 per case Ready to use PAPR Kits with M-200 Headtop |

## Ready to use PAPR Kits with M-200 Headtop

| 3M Order Code | Model #   | Description  |
|---------------|-----------|--|
| AT010587759   | 902-03-81 | Jupiter™ PAPR Kit c/w M-206C Faceshield Comfort F/Seal c/w Charger, JTM106C          |
| AT010589623   | 902-03-93 | Jupiter™ PAPR Kit c/w M-207C Faceshield Flame Resistant F/Seal with Charger, JTM107C |
| AT010590514   | TRM-106C  | TR-300+ PAPR Kit c/w M-206C Faceshield F/Seal c/w Charger                            |
| AT010590522   | TRM-107C  | TR-300+ PAPR Kit c/w M-207C Faceshield Flame Resistant F/Seal c/w Charger            |

# Versaflo™ M-300 Series High Impact Helmet

The Versaflo M-300 Series High Impact Helmet provides integrated protection from specific respiratory, head, eye and face hazards with optional hearing protection. Two options for different applications:

- M-306 features a general purpose faceseal for dusts, sprays and chemical processing.
- M-307 features a flame resistant faceseal for applications where hot particles may be present.
- Compatible with TR-300+, TR-600, TR-800, Jupiter units and supplied air regulators V-100, V-200, V-300, V-500



\*earmuff not included

XA007707467

| 3M Order Code | Model #  | Description  |
|---------------|----------|--|
| XA007707467   | M-306    | Versaflo Helmet with coated visor and comfort faceseal         |
| AT010782079   | M-306CAP | M-306 Headtop only with Cap Lamp Mount Bracket                 |
| XA007707475   | M-307    | Versaflo Helmet with coated visor and flame resistant faceseal |
| 70071564218   | M-316    | Airflow Deflector - 1 per case                                 |
| 70071564226   | M-350    | Head Suspension - 1 per case                                   |
| UU003029749   | M-354    | Forehead Seal - 1 per case                                     |

### Ready to use PAPR Kits with M-300 Headtop

| 3M Order Code | Model #   | Description  |
|---------------|-----------|--|
| AT010587767   | 902-03-82 | Jupiter™ PAPR Kit c/w M-306C Helmet Comfort F/ Seal c/w Charger, JTM306C |
| AT010589631   | 902-03-94 | Jupiter™ PAPR Kit c/wM-307C Helmet FlameRes. F/seal c/w Charger, JTM307C |
| AT010590530   | TRM-306C  | TR-300+ PAPR Kit c/w withM-306C Helmet Comfort F/seal c/w Charger        |
| AT010590548   | TRM-307C  | TR-300+ PAPR Kit c/w withM-307 Helmet Flame Res.F/seal) c/w Charger      |
| AT010620147   | TR6M-307  | TR-600 PAPR Kit c/wM-307C Helmet Flame Res.F/Seal c/w Charger            |



# Versaflo™ M-400 Series High Impact Helmet with Neck Protector

The Versaflo M-400 Series High Impact Helmet provides integrated protection from specific respiratory, head, eye and face hazards with neck and shoulder protection. Two options for different applications:

- M-406 features general purpose faceseal for dusts, spraying and chemical processing.
- M-407 features a flame resistant faceseal and neck shroud for applications where hot particles may be present.
- Compatible with TR-300+, TR-600, TR-800, Jupiter units and supplied air regulators V-100, V-200, V-300, V-500



| 3M Order Code | Model # | Description   |
|---------------|---------|---|
| XA007707483   | M-406   | Versaflo Helmet with high durability neck and shoulder shroud |
| XA007707491   | M-407   | Versaflo Helmet with flame resistant neck and shoulder shroud |
| UU003029475   | M-441   | Jaw Gasket - 1 per case                                       |
| UU008294819   | M-444   | Inner Collar - 1 per case                                     |
| UU008294108   | M-447   | Flame Resistant Outer Shroud - 1 per case                     |
| UU008294827   | M-448   | High Durability Outer Shroud - 1 per case                     |

## Ready to use PAPR Kits with M-400 Headtop

| 3M Order Code | Model #   | Description  |
|---------------|-----------|--|
| AT010587775   | 902-03-83 | Jupiter™ PAPR Kit c/w M-406C Helmet with Hi-Dura Shroud c/w Charger, JTM406C |
| AT010589649   | 902-03-95 | Jupiter™ PAPR Kit c/w M-407C Helmet Flame Res. Shroud c/w Charger, JTM407C   |
| AT010590555   | TRM-406C  | TR-300+ PAPR Kit c/w M-406C Hi-Dura Shroud c/w Charger                       |
| AT010590563   | TRM-407C  | TR-300+ PAPR Kit c/w M-407C Helmet Flame Res. Shroud) c/w Charger            |
| AT010620154   | TR6M-407  | TR-600 PAPR Kit c/w M-407C Helmet Flame Res.Shroud c/w Charger               |

# Powered Air Purifying Respirators

## Versaflo™ S-Series Hoods & Headcovers

Compatible with TR-300+, TR-600, TR-800, Jupiter units and supplied air regulators V-100, V-200, V-300, V-500



S-333SG



S-133S



S-757



S-433L



S-533S



S-855



S-657



S-655



S-533L

| 3M Order Code | Model # | Description  |
|---------------|---------|--|
| 52000045782   | S-133S  | Head Cover (Small) with integrated head harness, headtop fabric, spun bond polypropylene                                     |
| 52000045824   | S-133L  | Head Cover (Large) with integrated head harness, headtop fabric, spun bond polypropylene                                     |
| 52000045865   | S333SG  | Low lint Head Cover (Small/Grey) with integrated head harness - 1 per box, headtop fabric, polyurethane coated knitted nylon |
| 52000045881   | S333LG  | Low lint Head Cover (Large/Grey) with integrated head harness - 1 per box, headtop fabric, polyurethane coated knitted nylon |
| 52000045907   | S-433S  | Hood (Small) with integrated head harness - 1 per box, headtop fabric, spun bond polypropylene                               |
| 52000045923   | S-433L  | Hood (Large) with integrated head harness - 1 per box, headtop fabric, spun bond polypropylene                               |
| 52000045949   | S-533S  | Low Lint Hood (Small) with integrated head harness - 1 per box, headtop fabric, polyurethane coated knitted nylon            |
| 52000045964   | S-533L  | Low Lint Hood (Large) with integrated head harness - 1 per box, headtop fabric, polyurethane coated knitted nylon            |
| UU003722327   | S-655   | Hood with replaceable head suspension - 1 per box, headtop fabric, spun bond polypropylene                                   |
| UU003722335   | S-657   | Double Shroud Hood with replaceable head suspension - 1 per box, headtop fabric, spun bond polypropylene                     |
| UU003719109   | S-757   | Double Laminate Hood with replaceable head suspension - 1 per box, headtop fabric, spun bond polypropylene                   |
| 70071533338   | S-855   | Sealed seam hood with replaceable head harness - 1 per box, headtop fabric, spun bond polypropylene                          |

### Ready to use PAPR Kits with S-Series Headtop

| 3M Order Code | Model #   | Description   |
|---------------|-----------|---|
| AT010583410   | 902-03-35 | Jupiter™ PAPR Kit c/w S-655C Hood with charger JTS655C              |
| AT010583428   | 902-03-36 | Jupiter™ PAPR Kit c/w S-533C Hood with charger JTS533LC             |
| AT010583923   | 902-03-37 | Jupiter™ PAPR Kit c/w S-133C Hood with charger JTS133LC             |
| AT010591447   | TRS-133C  | TR-300+ PAPR Kit c/w S-133 Headcover c/w Charger                    |
| AT010591454   | TRS-333C  | TR-300+ PAPR Kit c/w S-333 Headcover c/w Charger                    |
| AT010591462   | TRS-433C  | TR-300+ PAPR Kit c/w S-433 Integrated HeadHarness Hood c/w Charger  |
| AT010591470   | TRS-533C  | TR-300+ PAPR Kit c/w S-533 Integrated Head Harness Hood c/w Charger |
| AT010591488   | TRS-655C  | TR-300+ PAPR Kit c/w S-655 Reusable HeadHarness Hood c/w Charger    |
| AT010591496   | TRS-657C  | TR-300+ PAPR Kit c/w S-657 Reusable Head Harness Hood c/w Charger   |

# Powered Air Purifying Respirators

## Jupiter™ Turbo System

Jupiter Air Turbo Unit includes turbo case, motor, blower, decontamination belt, battery and instructions. Battery Charger and Breathing Tube is not included.



| 3M Order Code | Model #       | Description                    |
|---------------|---------------|--------------------------------|
| AT010592726   | 902-01-79     | Jupiter AFU with Battery       |
| XA007706071   | 085-01-00P    | Blower Module                  |
| XA007706253   | 085-06-10P    | Control Module - Jupiter       |
| 52000043803   | 007-00-64P    | NIMH Battery Pack              |
| AT010596396   | 003-00-58PAUS | Battery Charger, CHG-02        |
| AT019167745   | 022-25-10P4   | Braces for Jupiter Belt System |
| 70071533015   | BT-20L        | Breathing Tube                 |
| 52000044306   | 003-00-59P    | Jupiter 10 Station Charger     |
| XA007708028   | 021-14-12P    | Jupiter™ Airflow Indicator     |

## Jupiter™ Intrinsically Safe Air Filter Unit

Jupiter IS Air Turbo Unit includes turbo case, motor, decontamination belt, pouch, battery and instructions. Battery Charger and Breathing Tube is not included.



| 3M Order Code | Model #       | Description                            |
|---------------|---------------|--|
| AT019202582   | 902-03-00     | Jupiter™ IS Turbo Battery and Pouch    |
| XA007706071   | 085-01-00P    | Blower Module                          |
| XA007706253   | 085-06-10P    | Control Module -                       |
| 52000044579   | 085-12-00P    | 4 Hour IS Battery and IS Pouch Jupiter |
| AT010596396   | 003-00-58PAUS | Battery Charger, CHG-02                |
| AT019167745   | 022-25-10P4   | Braces for Jupiter Belt System         |
| 70071533015   | BT-20L        | Breathing Tube                         |
| 52000044306   | 003-00-59P    | Jupiter 10 Station Charger             |
| XA007708028   | 021-14-12P    | Jupiter™ Airflow Indicator             |

## 3M Jupiter™ Powered Air Respirator Systems

Jupiter™ Integrated Powered Air Respirator system includes Headtop, Turbo unit, standard belt, breathing tube, battery pack, battery charger, select headtop, and tote bin/storage tub. Filters to be purchased separately.



AT010587767

| 3M Order Code | Model #   | Description  |
|---------------|-----------|--|
| AT010589623   | 902-03-93 | Jupiter™ PAPR Faceshield with Flame Resistant F/Seal with Charger, JTM207C   |
| AT010587767   | 902-03-82 | Jupiter™ PAPR Kit c/w M-306C Helmet Comfort F/ Seal c/w Charger JTM306C      |
| AT010613993   | 902-03-85 | Jupiter™ PAPR Kit c/w M-307C Helmet Flame Res. F/seal c/w Charger JTM306C-SB |
| AT010583410   | 902-03-35 | Jupiter™ PAPR Kit c/w S-655C Hood with charger                               |
| AT010583428   | 902-03-36 | Jupiter™ PAPR Kit c/w S-533C Hood with charger                               |
| AT010583923   | 902-03-37 | Jupiter™ PAPR Kit c/w S-133C Hood with charger JTS133LC                      |
| AT010587049   | 902-03-43 | Jupiter™ PAPR Kit c/w S-433C Hood with charger                               |

## Jupiter™ Filters



| 3M Order Code | Model #      | Description                               |
|---------------|--------------|---|
| CR180806000   | 450-00-25    | Particulate Filter - P3 PAPR              |
| CR180806018   | 453-00-25P   | Organic Vapor & Particulate Filter - A1P3 |
| CR180806042   | 453-09-25    | Multigas & Particulate - A1B1E1K1P3 PAPR  |
| CR180804708   | 461-00-02P24 | Pre Filter Discs - 24 per pack            |

## Powered Air Purifying Respirators

# Powerflow™ Powered Air Purifying Respirator

Powerflow includes 6000 DIN series full face mask Polycarbonate visor, waterproof motor, PAPR-P3 particulate filter, battery and user instructions.



| 3M Order Code | Model #   | Description                                   |
|---------------|-----------|---|
| AT019184095   | 902-02-12 | Powerflow™ 6800 Plus Full Face Respirator Kit |

### Filters

| 3M Order Code | Model # | Description      |
|---------------|---------|------------------|
| XP100544418   | 052670  | Pro2000 PF 10 P3 |

## 6800DIN Full Face Piece

The 6800 standard full face piece, fitted with a DIN adapter to allow a hose connection. This full face piece provides high levels of protection for powered air system users. Polycarbonate visor.



| 3M Order Code | Model # | Description       |
|---------------|---------|-------------------|
| AT010561333   | 6800DIN | Medium Face Piece |
| AT010601667   | 6900DIN | Large Face Piece  |



# 3M™ Scott Proflow SC160 PAPR

- Proflow SC160 comes with blower unit, battery, recharger, hose with DIN thread and PVC belt
- Lightweight and compact
- Continuous visible monitor of battery status and filter blockage
- Audible alarm for low battery and filter clogging
- Typical 6-7 hours use for a single charge
- NiMH high power battery with fast recharge
- Shower-proof construction enhances decontamination
- Low through life running costs



| 3M Order Code | Model # | Description                    |
|---------------|---------|--------------------------------|
| XP100544624   | 064580  | Proflow SC160 Green Power Pack |

## Proflow SC160 Ratings

| Open Headtop               | PAPR Rating |               |
|----------------------------|-------------|---------------|
| FH1 Half-hood              | PAPR P3     | PAPR B1E1K1P3 |
| FH2 Full-hood              | PAPR P3     | PAPR B1E1K1P3 |
| FH21 Anti-Static Full Hood | PAPR P3     | PAPR B1E1K1P3 |
| Face Masks                 |             |               |
| FM2 Sari Full Face Mask    | PAPR P3     | PAPR B1E1K1P3 |
| FM3 Promask Full Face Mask | PAPR P3     | PAPR B1E1K1P3 |
| FM4 Vision Full Face Mask  | PAPR P3     | PAPR B1E1K1P3 |

# Powered Air Purifying Respirators

## 3M™ Scott Pro2000 Filters for Proflow Powered Air Purifying (PAPR) Units

- This selection of Scott Pro2000 filters are suitable for use with the Proflow SC PAPR
- Dependant on the headtop selection the ratings on the filters below may change
- The particulate rating on the filters may vary between P1 and P3
- Scott Pro2000 filter canisters have a DIN 40mm thread connection
- Scott Pro2000 filter canisters also now compliant for use with Powerflow



042799



052670

| Filter Type | Colour    | Main area of application   |
|-------------|-----------|--|
| P           | White     | Particles: dusts, mists, fumes, fibres, toxic particles & microorganisms (bacteria, fungi, viruses, enzymes) |
| A           | Brown     | Organic gases and vapours with boiling point >65°C. eg. acid gases, toluene, xylene, mek, benzene, alcohols  |
| B           | Grey      | Gases. eg. chlorine, hydrogen, sulphide  |
| E           | Yellow    | Sulphur dioxide  |
| K           | Green     | Ammonia and organic ammonia derivatives  |
| Hg-P        | Red-White | Mercury (vapour) and mercury compounds   |

| 3M Order Code | Model # | Description            |
|---------------|---------|------------------------|
| XP100544418   | 052670  | Pro2000 PF 10 P3       |
| XP100544343   | 042799  | Pro2000 CF 32 B1E1K1P3 |



## 3M™ Scott Proflow SC160 PAPR Ready-Pak

- Ready-Pak comes with Proflow SC160 blower unit, battery, charger, EPDM hose, PVC belt, PAPR Respirator, two Pro2000 PF10 particulate filters and two storage solutions; stackable tub or carry case
- Ready-Paks available with Promask FF, Vision FF (side mounted filter connection), Sari FF Respirator



XP100544731



XP100231594



AT010660192

| 3M Order Code | Model #     | Description                           |
|---------------|-------------|---------------------------------------|
| XP100544731   | 5064594     | Promask Proflow SC 160 Ready-Pak      |
| AT010660234   | 5064594CASE | Promask Proflow SC 160 Ready-pak Case |
| AT010660192   | 5064594SARI | Sari Proflow SC160 Ready-Pak Tub      |
| XP100231594   | 5564593     | Vision Proflow SC 160 Ready-Pak Tub   |

## Proflow SC160 Hoses

| 3M Order Code | Model # | Description   |
|---------------|---------|---|
| XP100544541   | 063799  | EPDM hose (angle & DIN) 80cm for use with FM2, FM3, FM4 (comes standard with Proflow SC160) |
| XP100231560   | 5564453 | EPDM Rubber hose for use with FH1, FH2 and FH21   |
| XP100140605   | 2026226 | Fixed length PU for use with FH1, FH2 and FH21  |
| XP100140639   | 2026231 | Fixed length PU for use with FM2, FM3 and FM4   |

# Promask Full Face Mask (FM3) Respirator

- Choice of halo-butyl elastomer and silicone face piece material
- Unique speech diaphragm that for clearer speech transmission
- Easy disinfection, decontamination and maintenance
- Wide sealing edge provide superior fit
- T-bar 5 point head harness for increased wearer comfort and fit
- Sweat port in chin pocket providing added comfort during extended wear times
- Quick release headband
- Slim-line design allows easy integration with helmets and earmuffs
- Wide sealing edge provide superior fit
- Available in two sizes
- Choice of PU fixed length or EPDM hose (purchased separately)
- Certified to AS/NZS 1716:2012 PAPR P3 with Proflow SC160
- Polycarbonate visor



| 3M Order Code | Model # | Description   |
|---------------|---------|---|
| XP100544079   | 012681  | Promask (FM3) PAPR full face mask (M/L), no hose (PAPR P3)          |
| XP100547205   | 012670  | Promask (FM3) PAPR full face mask (S), no hose (PAPR P3)            |
| XP100547320   | 012882  | Promask Silicone (FM3) PAPR full face mask (M/L), no hose (PAPR P3) |

# Powered Air Purifying Respirators

## Sari Full Face Mask (FM2) Respirator

- Wide sealing edge for comfort and excellent fit
- Natural rubber front-port face mask, also available in Silicone material
- Comfortable to wear even for long periods
- Adjustable five-point rubber head harness
- Large distortion-free visor
- Available in 2 lens type; polycarbonate and triplex
- Speech diaphragm affords clear communication
- Choice of PU fixed length or EPDM hose (purchased separately)
- Certified to AS/NZS 1716:2012 PAPR P3 with Proflow SC160



| 3M Order Code | Model # | Description                             |
|---------------|---------|---|
| XP100547114   | 011680  | Sari Natural Rubber Polycarbonate visor |
| XP100544038   | 011685  | Sari Silicone Polycarbonate visor       |
| XP100215746   | 019805  | Sari Triplex Glass visor                |

## Vision Full Face Mask (FM4) Respirator

- Non dermatitic silicone construction minimises risk of skin irritation
- Reverted edge face seal ensuring good fit and increased safety
- High efficiency speech diaphragm allows wearer to communicate clearly
- Available in two sizes
- Choice of PU fixed length or EPDM hose (purchased separately)
- Certified to AS/NZS 1716:2012 PAPR P3 with Proflow SC160
- Polycarbonate visor



| 3M Order Code | Model #  | Description   |
|---------------|----------|---|
| XP100544962   | RFF4000  | Vision Silicone (FM4) PAPR Side mounted full face mask (M/L), no hose (PAPR P3) |
| XP100550118   | RFF4000S | Vision Silicone (FM4) PAPR Side mounted full face mask (S), no hose (PAPR P3)   |



# Powered Air Purifying Respirators

## Flowhood 1 (FH1) PAPR Headtop

- Soft half hood covering the face and the top of the head
- Unique Neoprene Face seal delivers high level protection without compromising comfort
- Made from lightweight and durable Polyurethane coated nylon fabric
- Large flexible PETG visor (0.75mm thick) with excellent field of view
- One size to fit many
- Provides air flow to head and face
- Wire reinforced polyurethane hose included
- For applications where impact protection is not required
- Complete with hose to suit PAPR
- Complies with AS/NZS 1716:2012 PAPR P3 with Proflow SC160



| 3M Order Code | Model # | Description   |
|---------------|---------|---|
| XP100136264   | 2022948 | Flowhood FH1 half hood (New) without hose   |
| XP100141710   | 2027037 | PAPR Bayonet adaptor pack upgrade kit (needs to be added to Proflow SC160 for using FH1, FH2 & FH2) |

## Flowhood 2 (FH2) PAPR Headtop

- Soft full hood covering the head and the top of the shoulders
- Unique Neoprene Face seal delivers high level protection without compromising comfort
- Incorporates a drawstring neck seal
- Made from lightweight and durable Polyurethane coated nylon fabric
- Large flexible PETG visor (0.75mm thick) with excellent field of view
- Provides air flow to head and face
- One size to fit many
- Wire reinforced polyurethane hose included
- For applications where impact protection is not required
- Suitable for wearers with beards or spectacles
- Complete with hose to suit PAPR
- Complies with AS/NZS 1716:2012 PAPR P3 with Proflow SC160



| 3M Order Code | Model # | Description   |
|---------------|---------|---|
| XP100136272   | 2022949 | Flowhood FH2 full hood (New) without hose   |
| XP100141710   | 2027037 | PAPR Bayonet adaptor pack upgrade kit (needs to be added to Proflow SC160 for using FH1, FH2 & FH2) |

## Flowhood 21 (FH21) PAPR Headtop

- Soft anti-static full hood covering the head and the top of the shoulders
- Unique Neoprene Face seal delivers high level protection without compromising comfort
- Incorporates a drawstring neck seal
- Made from lightweight and durable Polyurethane coated nylon fabric
- Large flexible PETG visor (0.75mm thick) with excellent field of view
- Provides air flow to head and face
- One size to fit many
- Wire reinforced polyurethane hose included
- For applications where impact protection is not required
- Suitable for wearers with beards or spectacles
- Complete with hose to suit PAPR
- Complies with AS/NZS 1716:2012 PAPR P3 with Proflow SC160

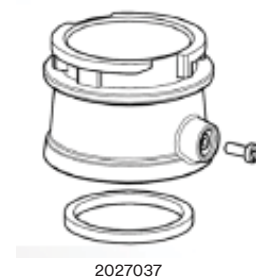

**PLEASE NOTE**  
 XP100141710 2027037 PAPR Bayonet adaptor pack upgrade kit (needs to be purchased additionally and added to Proflow SC160 for using FH1, FH2 & FH21)

| 3M Order Code | Model # | Description  |
|---------------|---------|--|
| XP100136488   | 2023098 | Each flowhood 21AS full as hood (New) no hose  |
| XP100141710   | 2027037 | PAPR Bayonet adaptor pack upgrade kit (needs to be added to Proflow SC160 for using FH1, FH2 & FH21) |

# Headtop selection guide.

| Industry                   | FH1 | FH2 | FH21 | FM2 | FM3 | FM4 |
|----------------------------|-----|-----|------|-----|-----|-----|
| Laboratories               | ■   | ■   | ■    | ■   | ■   | ■   |
| Textiles                   | ■   | ■   | ■    | ■   | ■   | ■   |
| GRP Manufacture            | ■   | ■   | ■    | ■   | ■   | ■   |
| Food Processing            | ■   | ■   |      | ■   | ■   |     |
| Flour Mills and Silos      | ■   | ■   |      | ■   | ■   | ■   |
| Agriculture                | ■   | ■   |      | ■   | ■   | ■   |
| Wineries/Market Gardens    | ■   | ■   |      | ■   | ■   | ■   |
| Pest Control               | ■   | ■   | ■    | ■   | ■   | ■   |
| Animal Allergies           | ■   | ■   | ■    | ■   | ■   | ■   |
| DIY                        | ■   | ■   |      |     |     |     |
| Pharmaceutical             | ■   | ■   | ■    | ■   | ■   | ■   |
| Foundries                  |     |     |      | ■   | ■   |     |
| Lead Processing            |     |     |      | ■   | ■   | ■   |
| Aluminium Works            |     |     |      |     |     | ■   |
| Steel Industry             |     |     |      | ■   | ■   |     |
| Shipyards                  |     |     |      | ■   | ■   |     |
| Welding                    |     |     |      |     |     |     |
| Tunnelling/Quarrying       |     |     |      | ■   | ■   |     |
| Mining                     |     |     |      | ■   | ■   |     |
| Demolition & Maintenance   |     |     |      | ■   | ■   |     |
| Building & Construction    |     |     |      | ■   | ■   |     |
| Purification & Sewage      |     | ■   | ■    | ■   | ■   | ■   |
| Waste Disposal             | ■   | ■   | ■    | ■   | ■   | ■   |
| Chemical Plants            | ■   |     | ■    | ■   | ■   | ■   |
| Petrochemical              |     |     | ■    | ■   | ■   | ■   |
| Nuclear                    |     |     | ■    | ■   | ■   | ■   |
| Electronic/PCB Manufacture | ■   | ■   | ■    | ■   | ■   | ■   |
| Paint Spraying             |     |     |      | ■   | ■   | ■   |